

CONTEMPORARY ROUND

Features

- Single-function Rain showerhead
- MasterClean™ spray nozzles prohibit mineral buildup for easy cleaning
- Katalyst™ Spray Technology with air induction ball joint (patent pending)
- Optimized sprayface for maximum performance
- Solid brass construction
- 2.5 gallon (9.5 L) per minute flow rate
- 1/2" - 14 NPT connection

**RAIN SHOWERHEAD
K-13688**

ALSO K-13689, K-13690, K-13691

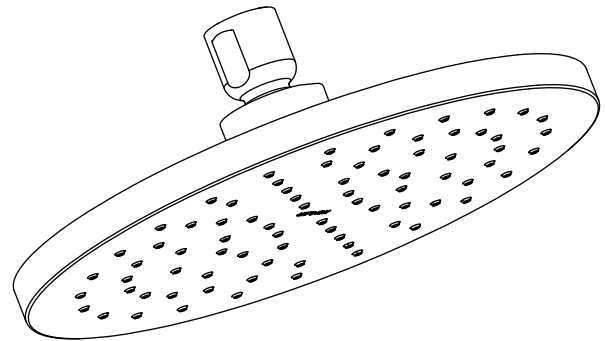

Codes/Standards Applicable

Specified model meets or exceeds the following:

- ASME A112.18.1/CSA B125.1
- Energy Policy Act of 1992

Colors/Finishes

- CP: Polished Chrome
- Other: Refer to Price Book for additional colors/finishes

Accessories

- CP: Polished Chrome
- Other: Refer to Price Book for additional colors/finishes

Specified Model

Model	Description	Size	Nozzles	Colors/Finishes	
K-13688	Rain showerhead	8" (203 mm)	78	<input type="checkbox"/> CP	<input type="checkbox"/> Other____
K-13689	Rain showerhead	10" (254 mm)	78	<input type="checkbox"/> CP	<input type="checkbox"/> Other____
K-13690	Rain showerhead	12" (305 mm)	102	<input type="checkbox"/> CP	<input type="checkbox"/> Other____
K-13691	Rain showerhead	14" (356 mm)	126	<input type="checkbox"/> CP	<input type="checkbox"/> Other____

Optional Accessories

K-7392	12" (305 mm) straight ceiling-mount shower arm and flange	<input type="checkbox"/> CP	<input type="checkbox"/> Other____
K-7394	6" (152 mm) straight ceiling-mount shower arm and flange	<input type="checkbox"/> CP	<input type="checkbox"/> Other____
K-7396	3" (76 mm) straight ceiling-mount shower arm and flange	<input type="checkbox"/> CP	<input type="checkbox"/> Other____
K-10124	Right-angle shower arm and flange	<input type="checkbox"/> CP	<input type="checkbox"/> Other____

Product Specification

The single function rain showerhead shall be made of solid brass construction with MasterClean™ spray nozzles to prohibit mineral build up for easy cleaning. Showerhead shall have Katalyst™ spray technology with air induction ball joint (patent pending) and optimized spray face for maximum performance. Showerhead shall have a flow rate of 2.5 gallons (9.5 L) per minute. Showerhead shall have a 1/2"-14 NPT connection. Showerhead shall be Kohler Model K-13688-____, K-13689-____, K-13690-____ or K-13691-____.

CONTEMPORARY ROUND

Installation Notes

Install this product according to the installation guide.

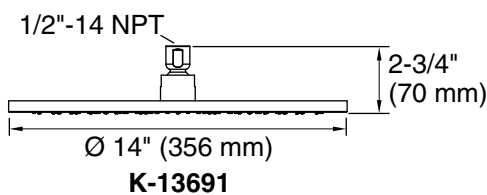
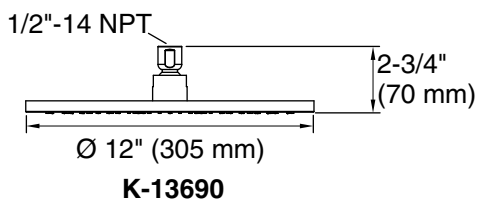
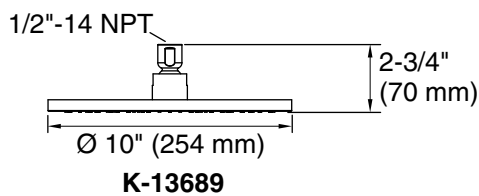
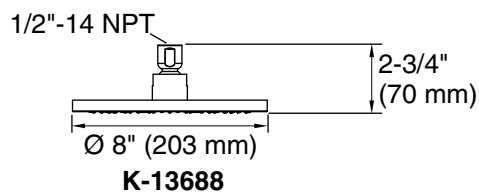

Product Diagram